

Multi-Piece Shower with Trench Drain

(For models requiring mud set)



1069

This packet includes installation instructions for the Bestbath® products shown below.

(These instructions also available at www.bestbath.com)

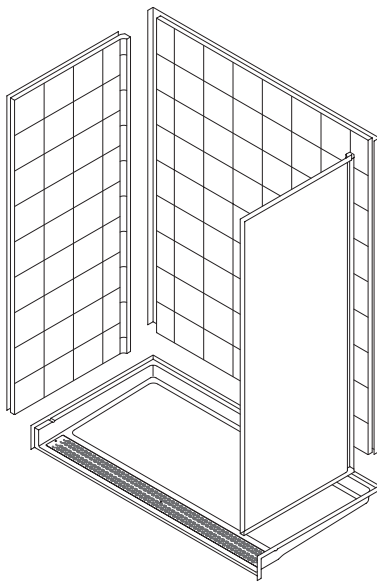

4-piece Multi-Piece Shower System with Trench Drain

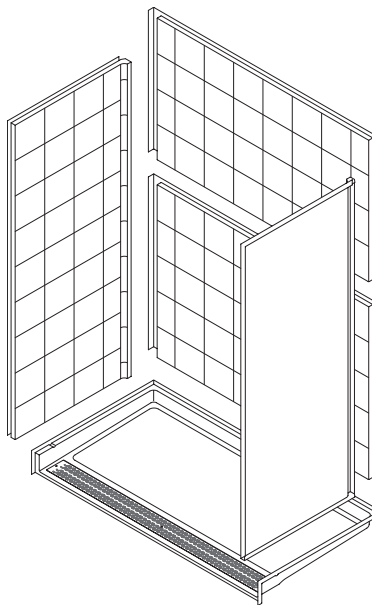

5-piece Multi-Piece Shower System with Trench Drain

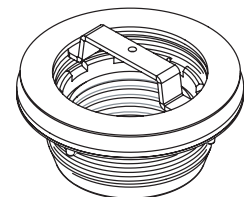

No-Caulk Shower Drain

Pre-Installation Prep.....	2
Preparing the Shower Pocket.....	2
Installing the Shower Pan and No-Caulk Drain	3–5
Installing Shower Walls	6–7
Installing the Trench Grate.....	8

Before you begin installation, please carefully read all instructions regarding the proper installation of your shower unit.

Multi-Piece Shower System with Trench Drain

PRE-INSTALLATION PREP

1 CHECK PARTS INVENTORY

If any parts are damaged, immediately file a claim with the carrier. Minor damage (scuffs and scrapes) can be touched up later.

- Pan
- Side walls
- Back wall (1 or 2 pieces, depending on model)
- Drain grate and installation components:
 - Drain grate support bracket
 - Two pan head screws
 - One flat head screw
- Joint sealant
- No-caulk drain
- *Optional:* Flange trim kit for walls

2 GATHER SUPPLIES

- 1½" screws for flange attachment (recommend washer-head, self-drilling type)
- Shim wedges
- Four pieces 2x4 lumber, 8 ft. long (for walls; see **Preparing Shower Pocket** at right)
- Mud set (for under pan)
- Screw gun
- Screw driver
- Adjustable pliers
- Standard caulk gun
- Broom
- Level
- Measuring tape
- Pencil or marker

Please read all instructions provided in this guide prior to installation.

PREPARING SHOWER POCKET



Top of nailing flange, plus 1".

- 1 Mark and cut out drywall to fit back and side walls of shower. Remove drywall 1" beyond side wall and top nailing flanges. (Figures 1 and 2)

Figure 1

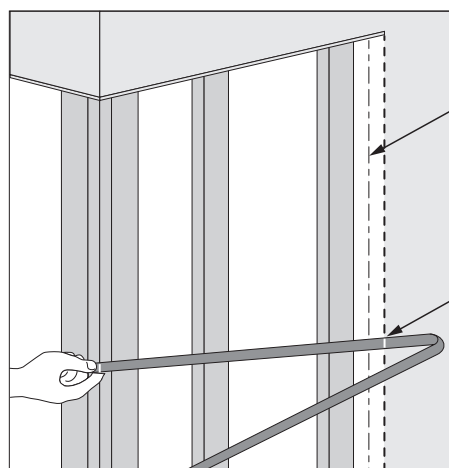

Front edge of side wall flange

Measuring from the corner, cut out drywall 1" beyond shower side wall flange

Figure 2

- 2 Install studs to provide support for flange and drywall attachment. (Figure 3)

EXAMPLE OF TYPICAL STUD LAYOUT—TOP VIEW

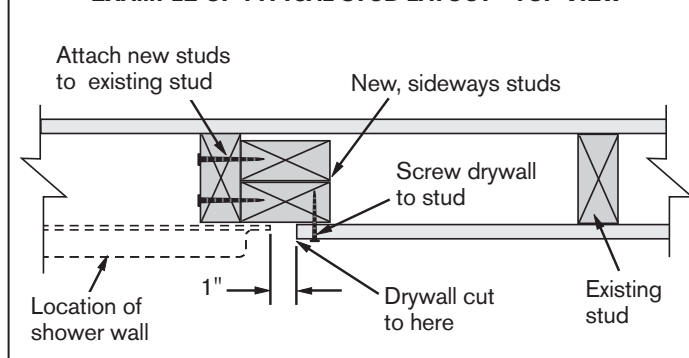

Figure 3

- 3 Rough in plumbing valve and drain per manufacturer's specifications.

Multi-Piece Shower System with Trench Drain

INSTALLING THE SHOWER PAN

! CAUTION: IF NOT INSTALLED PROPERLY, THE SHOWER PAN MAY NOT PERFORM AS DESIGNED AND WILL NOT BE COVERED BY THE WARRANTY.

CROSS-SECTION OF SHOWER PAN (INSTALLED)

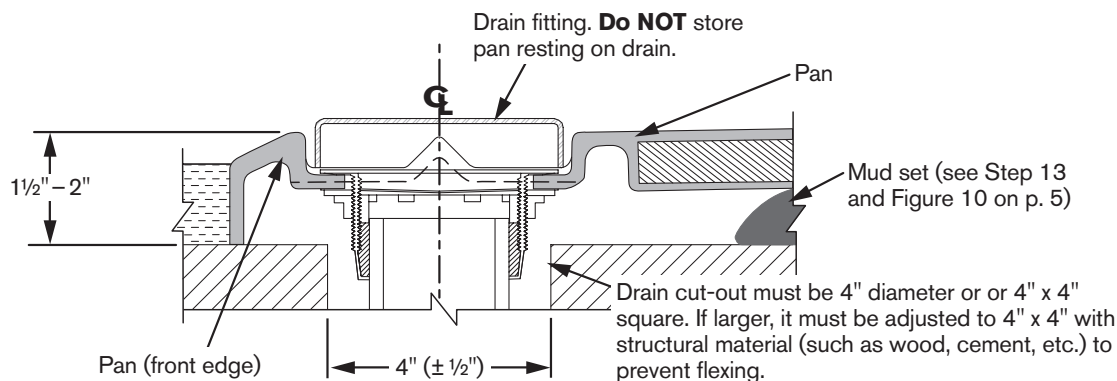

Figure 4

- 1** Check shower pocket area for level and for correct dimensions. Make sure drain hole in floor is the correct distance from studs and 4" diameter (or 4" x 4" square). The floor must be within 1/8" of level, especially around drain box-out. (Figure 5)

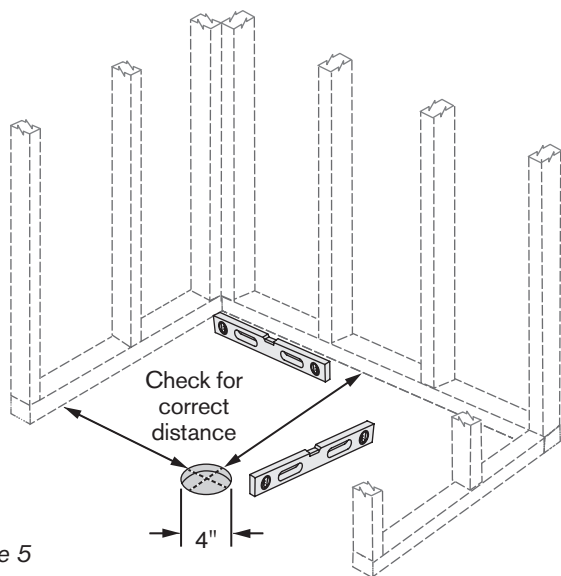

Figure 5

! Drain cut-out must be 4" diameter or 4" x 4". Drain pipe must be centered in cut-out.

- 2** Have a plumber prepare drain pipe to receive the drain; the pipe must be centered in the 4" cutout.

- 3 DRY-FIT THE PAN:** Set pan in the pocket. You **MUST** either dry-fit the shower walls or use a level to ensure pan is level, without low spots, and positioned correctly. Shim if necessary. Draw a line on the floor along front edge of pan. (Figure 6)

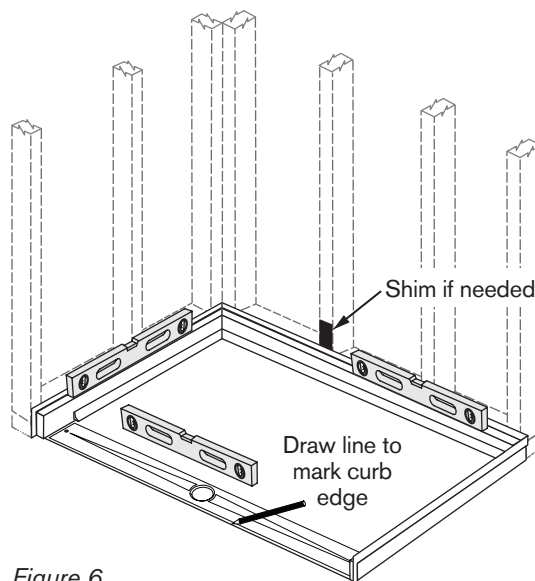

Figure 6

- 4** Remove pan from the framing pocket.
- 5 INSTALL DRAIN IN PAN** (see page 4).

! To avoid deforming the pan, once drain is installed DO NOT store the pan resting on the drain.

(continued on page 4)

Multi-Piece Shower System with Trench Drain

INSTALLING THE NO-CAULK DRAIN

NOTE: Do not complete drain installation steps below until you are ready to dry-fit the pan (see Step 3 on page 3). Resting the pan on the drain may deform the pan and cause gaps between the floor and pan when installed.

- 6 Remove inside compression nut and compression gasket.
- 7 Apply silicone or plumber's putty around shower pan drain hole on the inside of shower only. (Figure 7)
- 8 Install drain body in shower pan drain hole.
- 9 Install rubber gasket, fiber gasket and locking nut; tighten locking nut.

Note: The balance of the drain installation will be done after the pan is installed. See Step 15 on page 5.

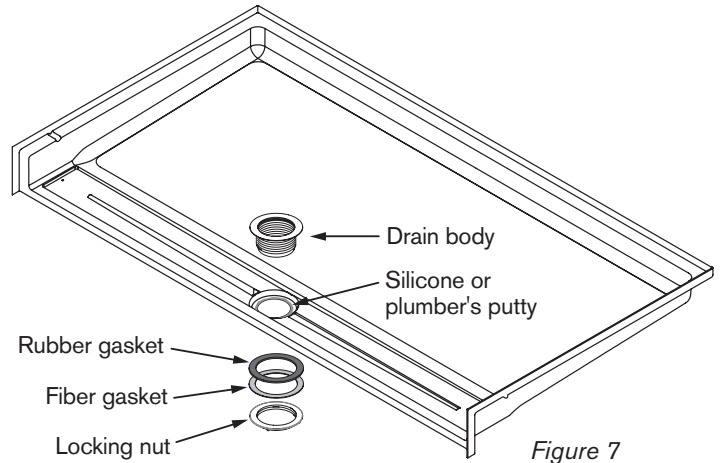

Figure 7

! To avoid deforming the pan, **DO NOT** rest the pan on the drain. This will help prevent gaps between the floor and the pan during installation.

CROSS-SECTION OF NO-CAULK DRAIN (INSTALLED)

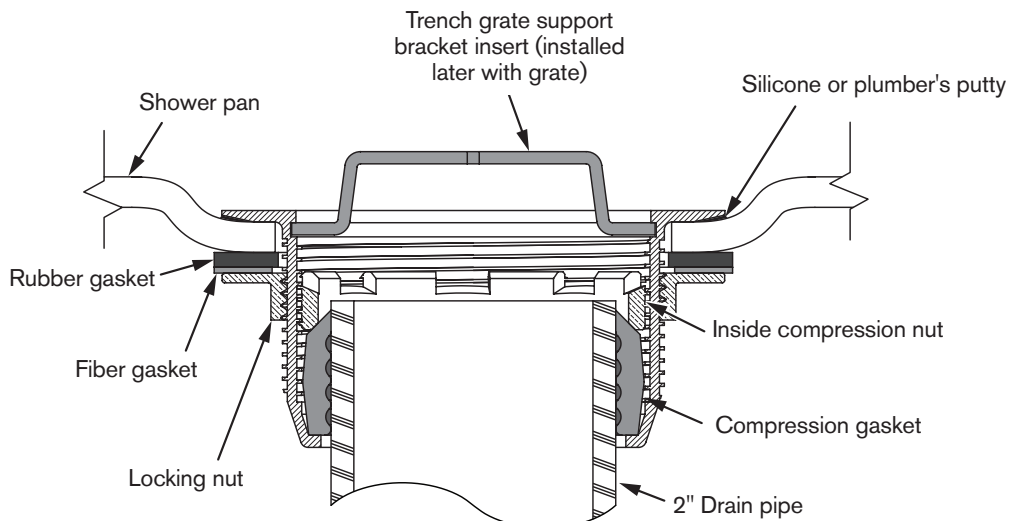

Figure 8

Multi-Piece Shower System with Trench Drain

INSTALLING SHOWER PAN (CONTINUED)

- 10 Sweep the floor and remove all debris from pocket area so mud set will adhere to the floor properly. The floor may be damp but there should be no standing water.
- 11 Clean underside of pan to remove any debris stuck to it.
- 12 Before applying the mud set, mark the floor with the pattern and spacing shown below. (Figure 9)

! For proper performance, it is critical that mud set is placed exactly as shown.

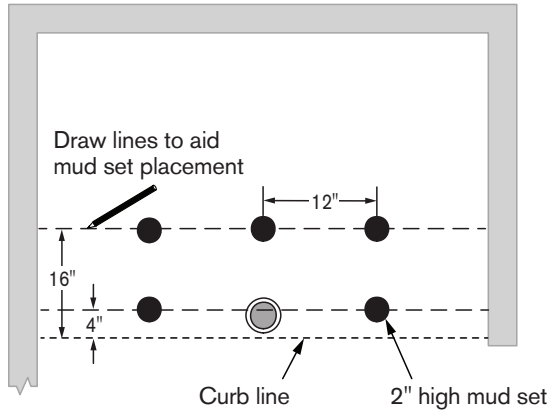

Figure 9

- 13 Place pan in pocket and prop it up while you apply the mud set. Place thick (2" high, minimum) dollops following the pattern you marked on the floor. The mud set will fill the void to help support the pan. (Figure 10)

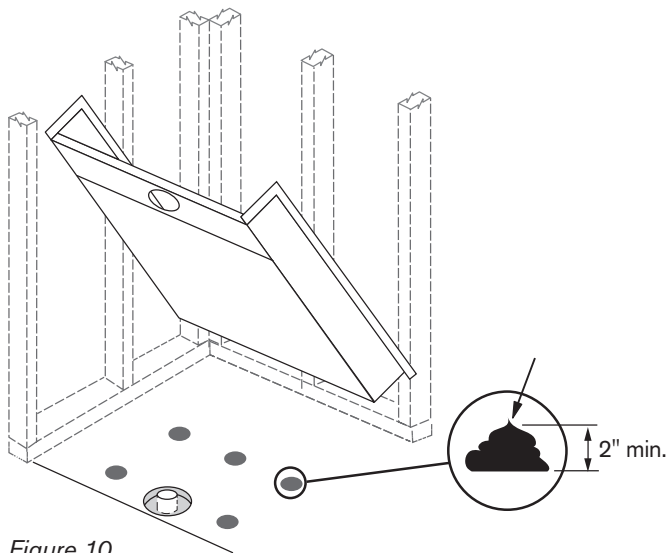

Figure 10

! Mud set is used to support the shower unit. It should not be used for leveling the subfloor. If the subfloor does not meet stated requirements, please use an appropriate product to level the subfloor prior to installation.

- 14 Lower pan into position; **do not drag or slide it**. Make sure the front aligns with curb line drawn in Step 3. Avoid stepping on pan until mud set has cured; follow curing instructions for mud set being used. Check ledges and front edge with a level. (Figure 11)

! DO NOT step on pan until mud set has cured.

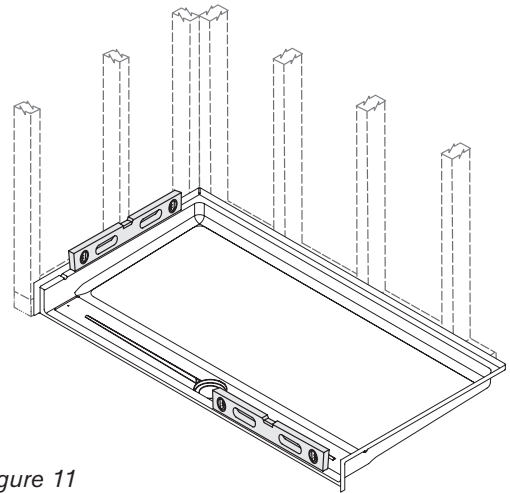

Figure 11

- 15 **FINISH DRAIN INSTALLATION:** Slide inside compression gasket into drain body and slip over pipe. **Make sure beveled end of inside compression gasket is facing up and flush with pipe surface.** (Figure 12)
- 16 Tighten inside compression nut into drain body using the tool provided. Keep grate support bracket with drain grate until ready to install.

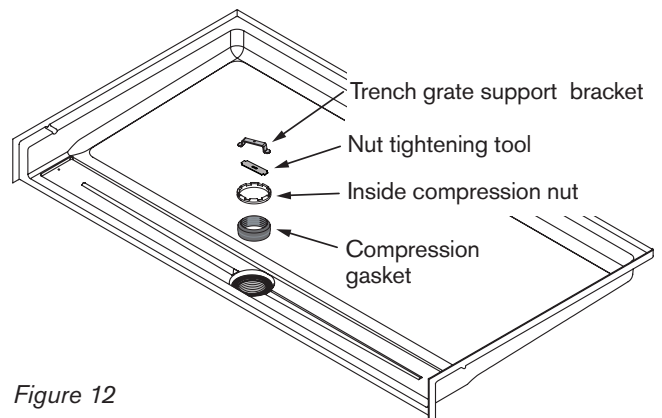
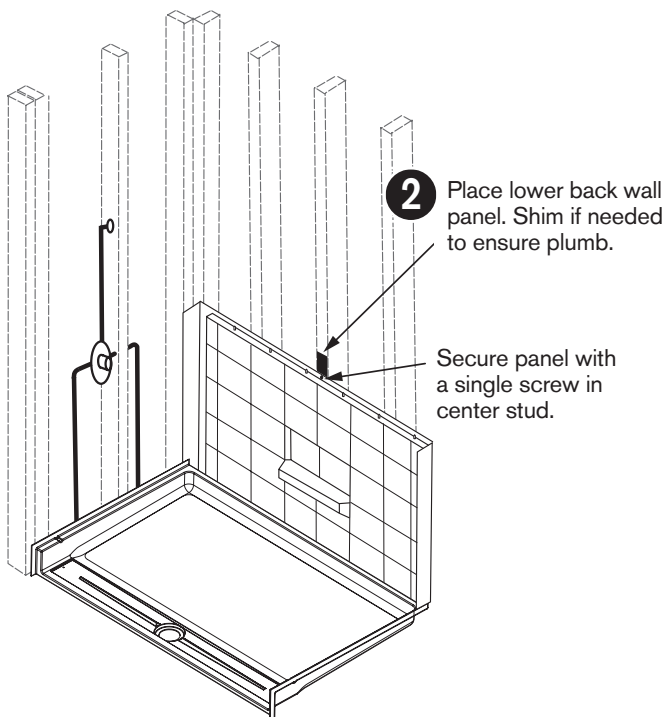
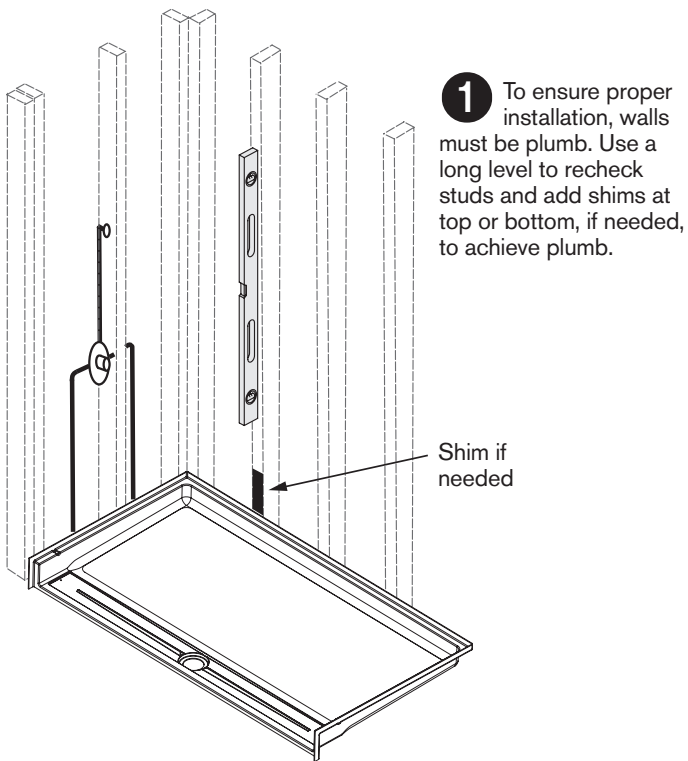

Figure 12

- 17 When mud set is fully cured, screw flanges to framing.
- 18 The grate is typically installed after the room is finished. To avoid damage, store grate in a safe place until it is installed.

INSTALLING SHOWER WALLS



- 3** Place upper panel and hold it in place with one screw near the center. **Do not completely tighten screw.** Add shims to keep wall straight if needed.

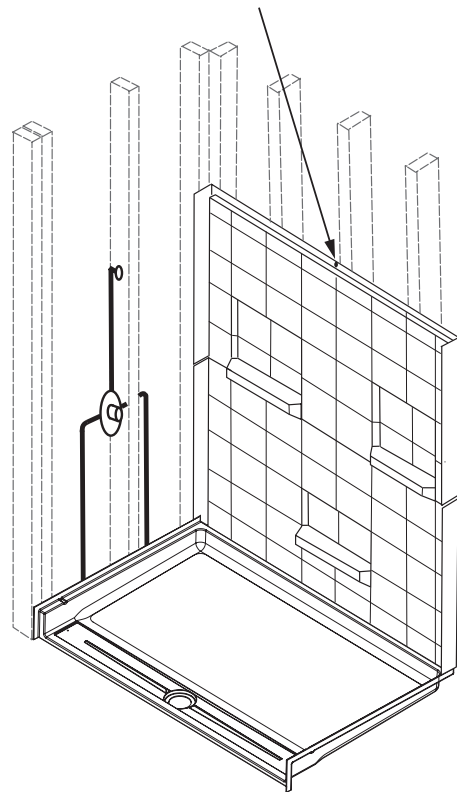

- 4** Drill plumbing holes in side wall panel; then proceed to side wall installation (**Step 5A or 5B** on page 7).

Multi-Piece Shower System with Trench Drain

INSTALLING SHOWER WALLS (CONTINUED)

- 5A SnapJoint Walls:** If your walls have the SnapJoint hardware shown below, proceed with steps A1 and A2.

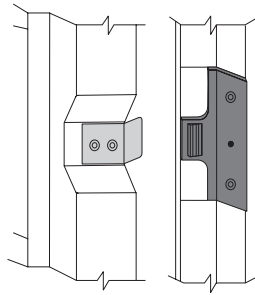

A1 Installing valve wall:

If parts of the shower valve and/or pipe nipple stick out:

- (1) Completely insert side wall at an angle to clear them;
- (2) Rotate the wall into place; Push wall until front is flush with pan.

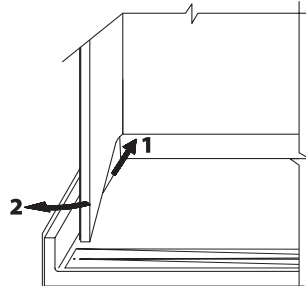

A2 Installing non-valve wall:

Rest side wall on pan ledge, then push it into the wall channel until front is flush with pan.

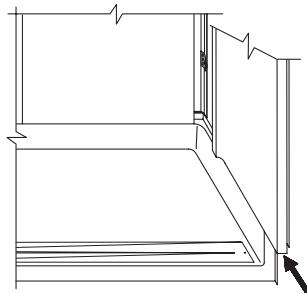

- 5B SpringClip Walls:** If your walls have the SpringClip hardware shown below, proceed with steps B1–B3.

- B1** Unless you are doing a dry fit first, apply a generous dollop of construction adhesive (included) between the flange and the back of each SpringClip as shown. After applying the adhesive, proceed directly to step B2.

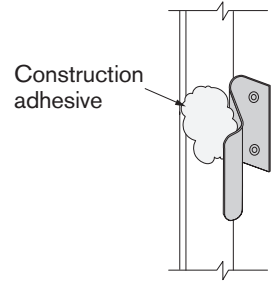

B2 Installing valve wall:

- (1) Holding side wall angled inward, insert it at the lowest SpringClip first.
- (2) Pivot the wall up to engage the remaining clips.
- (3) Keep side wall completely inserted but still angled to clear the shower valve and/or pipe nipple.
- (4) Rotate wall over plumbing. Push wall in until front is flush with pan.

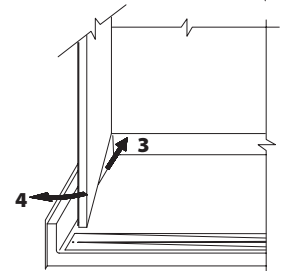
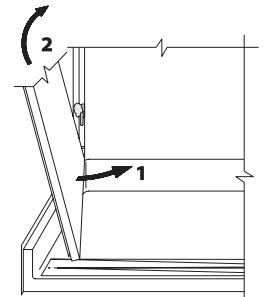

B3 Installing non-valve wall:

Holding side wall angled inward, insert it at the lowest SpringClip first, then rotate wall in to insert it at the higher clips. Push wall in until front is flush with pan.

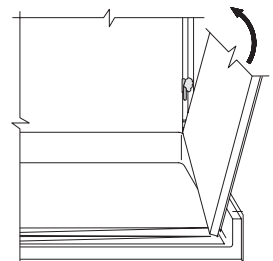

- 6** With walls firmly pushed down and front edge of side wall aligned with front edge of pan, screw through side wall flanges into framing.

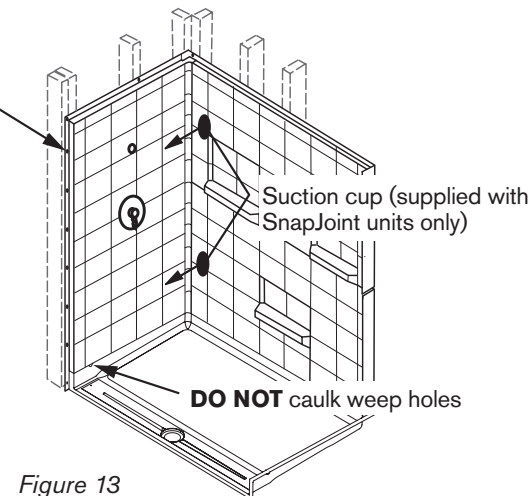

Figure 13

- 7 For SnapJoint Walls ONLY:** With a suction cup on lower back wall panel, pull it firmly forward until back and side walls are pulled together. You will hear a series of clicks as the panel locking clip engages. Repeat with upper panel. (Figure 13)

- 8** Screw top flange of back wall to studs. Apply silicone caulk in all joints **except weep holes**, which are located near the front on the seam between the pan and side wall. (Figure 13)

Multi-Piece Shower System with Trench Drain

INSTALLING THE TRENCH GRATE

Bestbath now offers two grate types: traditional screw-down or magnetic. First determine which grate you have, then follow the appropriate steps below.

- 1** Gather required parts and tools.

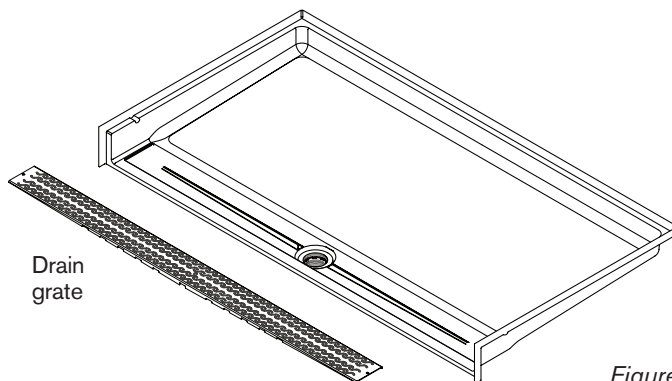
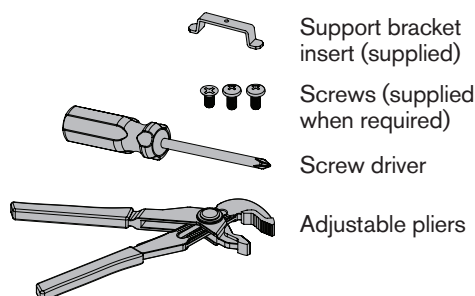

Figure 10

- 2** Using the adjustable pliers, snap the support bracket into the groove in the drain fitting. The top surface of the support bracket should be flush with the top surface of drain pyramids. (Figure 11)

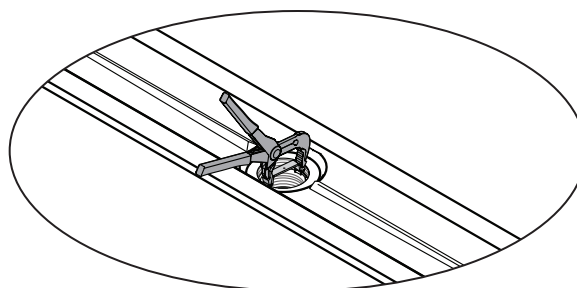

Figure 11

- 3 For screw-down grate:**

Set the drain grate in place and line up the two outside mounting holes. Then check to see if the center hole is aligned with the threaded hole in the support bracket.

If the center mounting hole does not line up, remove drain grate and adjust support bracket to center the location of the threaded mounting hole. (Figure 12)

For magnetic grate:

Place grate in trench. Check that it is centered both front to back and side to side. Press down firmly to ensure magnets make solid contact.

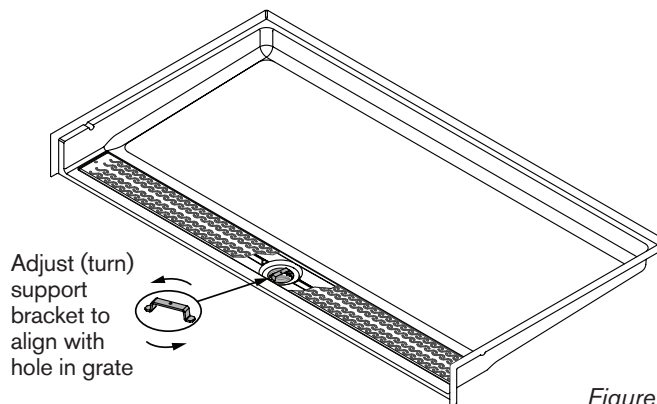

Figure 12

- 4 For screw-down grate:**

When all mounting holes are aligned, install the flat head screw in center hole (A). **Do not tighten.** Then install the two pan head screws in each of the end mounting holes (B). Do not tighten. Once all screws are in place, tighten screw in center first, then tighten screws in the end holes. (Figure 13)

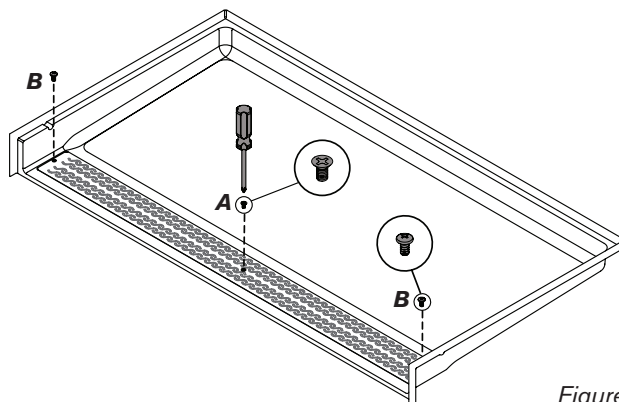

Figure 13